

36 412 000 EUROSMART COSMOPOLITAN E BLUETOOTH INFRA-RED ELECTRONIC BASIN MIXER 1/2" WITH MIXING DEVICE AND ADJUSTABLE TEMPERATURE LIMITER

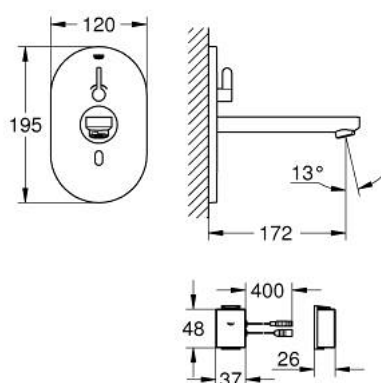

PRODUCT DESCRIPTION (1/2)

- Colour: chrome
- with infrared sensor and Bluetooth module for bi-directional communication for monitoring, configuration and service purpose
- with transformer 100-240 V AC, 50-60 Hz, 6.75 V DC
- set for final installation for concealed fitting box
- 36 339 001
- GROHE Long-Life finish
- maximum flow rate (at 3 bar): 8 l/min
- laminar flow straightener
- chrome escutcheon and spout
- projection 172 mm
- with Bluetooth® 4.0* for wireless data communication
- for Apple** and Android devices
- Bluetooth range (max. 10 m) varies depending on used materials and walls between transmitter and receiver
- monitoring
- password protected products
- app detects all Bluetooth products in range
- auto flush cycles and timing last auto flush
- usage per day / 30 days
- thermal disinfection cycles and timings last disinfection
- configuration
- detection range and shut off delay
- auto flush
- thermal disinfection
- cleaning mode
- 2 on/off timers
- identification by name
- service
- send and save 3 profiles
- reset to factory or user settings
- hard and software version
- CE approved

36 412 000 EUROSMART COSMOPOLITAN E BLUETOOTH INFRA-RED ELECTRONIC BASIN MIXER 1/2" WITH MIXING DEVICE AND ADJUSTABLE TEMPERATURE LIMITER

PRODUCT DESCRIPTION (2/2)

- acoustic group I in accordance with DIN 4109
- Mobile devices and GROHE IR Remote App*** are not included in delivery and have to be ordered separately via an authorised Apple store/store/iTunes or Google Play store.
- * The Bluetooth® word mark and logos are registered trademarks owned by Bluetooth SIG, Inc. and any use of such marks by Grohe AG is under license. Other trademarks and trade names are those of their respective owners.
- ** Apple, the Apple logo, iPod, iPod Touch, iPhone and iTunes are trademarks of Apple Inc., registered in the U.S. and other countries. Apple is not responsible for the function of this device or its compliance with safety and regulatory standards.
- *** Available for free via iTunes app or Google Play store.

36 412 000 EUROSMART COSMOPOLITAN E BLUETOOTH INFRA-RED ELECTRONIC BASIN MIXER 1/2" WITH MIXING DEVICE AND ADJUSTABLE TEMPERATURE LIMITER

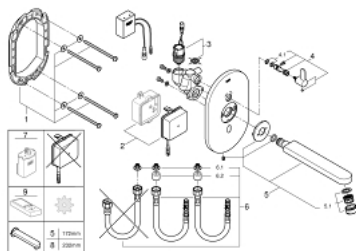

SELECT SPARE PART: , October 2018 – spareParts.validDate.now

- 1: Frame (Order-nr. 42419000)
- 2: Switching power supply (Order-nr. 42470000)
- 3: Solenoid valve (Order-nr. 42469000)
- 4: Mixing lever (Order-nr. 42441000)
- 4.1: Seat washer (Order-nr. 4284000M)
- 5: Spout (Order-nr. 42420000)
- 5.1: Economy Mousseur (Order-nr. 13951000)
- 5.1: Flow straightener (Order-nr. 13960000)
- 6: Connection hose set (Order-nr. 42417000)
- 6.1: Filter (Order-nr. 4241300M)
- 6.2: Non-return valve (Order-nr. 4240400M)
- 7: Battery housing (Order-nr. 42393000)*
- 8: Spout (Order-nr. 42418000)*
- 9: Remote control (Order-nr. 36407001)*
- * Optional accessories