

32 917 AL0 MINTA SINGLE-LEVER SINK MIXER 1/2"



PRODUCT DESCRIPTION

- Colour: brushed hard graphite
- C-spout
- single hole installation
- GROHE Long-Life finish
- GROHE SilkMove 46 mm ceramic cartridge
- adjustable flow rate limiter
- swivel tubular spout
- selectable swivel area: 0° / 150° / 360°
- flexible connection hoses
- connector set 3/8"
- rapid installation system
- optional temperature limiter ref. no. 46 308
- maximum flow rate (at 3 bar): 11.5 l/min



32 917 AL0 MINTA SINGLE-LEVER SINK MIXER 1/2"

SELECT SPARE PART: , March 2018 – spareParts.validDate.now

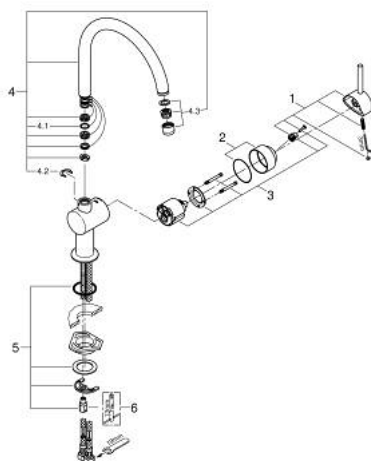

1: Lever (Order-nr. 46015AL0)

2: Shield (Order-nr. 46025AL0)

3: Cartridge (Order-nr. 46048000)

4: C-spout (Order-nr. 13043AL0)

4.1: Sealing washer (Order-nr. 0128500M)

4.2: Safety ring (Order-nr. 0485300M)

4.3: Mousseur (Order-nr. 13928AL0)

5: Shank mounting kit (Order-nr. 46249000)

6: Mounting wrench (Order-nr. 19017000)*

* Optional accessories