

31 930 001 **COSTA L TWO-HANDLE SINK MIXER**

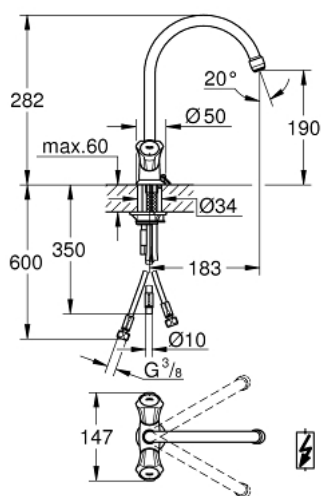

PRODUCT DESCRIPTION

- Colour: chrome
- for open water heater
- metal handles
- heat-insulated
- GROHE Long-Life finish
- GROHE Long-Life headparts
- flow straightener
- swivel tubular spout
- swivel area 360°
- chain ring
- copper pipes
- maximum flow rate (at 3 bar): 8.4 l/min



31 930 001 COSTA L TWO-HANDLE SINK MIXER

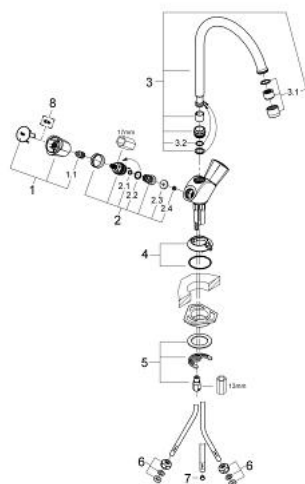

SELECT SPARE PART: , June 2008 – spareParts.validDate.now

1: Handle (Order-nr. 45994000)

1.1: Repl. kit f.handle fastening (Order-nr. 0538600M)

2: Headpart 1/2" (Order-nr. 07146000)

2.1: O-ring $\varnothing 6 \times \varnothing 2$ (Order-nr. 0128300M)

2.2: O-ring $\varnothing 18.2 \times \varnothing 1.7$ (Order-nr. 0392400M)

2.3: Ball seal dia. 9x6.8 mm (Order-nr. 0529100M)

3: High U-Outlet (Order-nr. 13227000)

3.1: Flow straightener (Order-nr. 08599000)

3.2: O-ring dia. 12x2 mm (Order-nr. 0128000M)

4: Escutcheon (Order-nr. 48005000)

5: Shank mounting kit (Order-nr. 46249000)

6: Connection thread $3/8 \times \varnothing 8,5$ (Order-nr. 1293800M)

7: Flow restrictor (Order-nr. 45303000)

8: Screw for Costa/Avina products (Order-nr. 48013000)*

* Optional accessories