

31 812 001 **COSTA L TWO-HANDLE SINK MIXER**

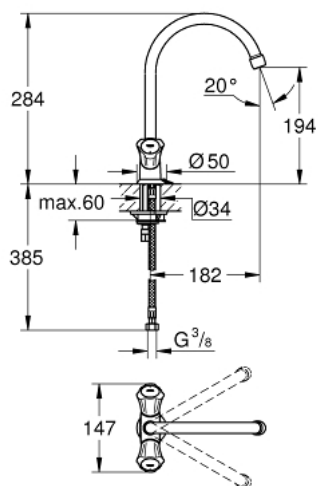

**PRODUCT DESCRIPTION**

- Colour: chrome
- metal handles
- heat-insulated
- screwable
- GROHE Long-Life finish
- GROHE Long-Life headparts
- mousseur
- swivel tubular spout
- swivel area 360°
- chain ring
- flexible connection hoses
- maximum flow rate (at 3 bar): 13 l/min



## 31 812 001 **COSTA L TWO-HANDLE SINK MIXER**

**SELECT SPARE PART:** , September 2016 – spareParts.validDate.now

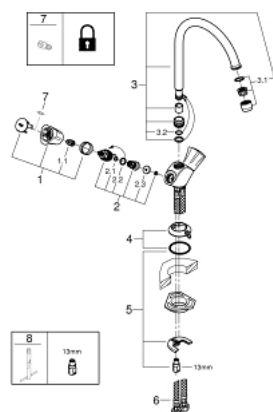

1: Handle (Order-nr. 45994000)

1.1: Repl. kit f.handle fastening (Order-nr. 0538600M)

2: Headpart 1/2" (Order-nr. 07146000)

2.1: O-ring  $\varnothing 6 \times \varnothing 2$  (Order-nr. 0128300M)

2.2: O-ring  $\varnothing 18.2 \times \varnothing 1.7$  (Order-nr. 0392400M)

2.3: Ball seal dia. 9x6.8 mm (Order-nr. 0529100M)

3: Spout (Order-nr. 13213000)

3.1: Mousseur (Order-nr. 13928000)

3.2: O-ring dia. 12x2 mm (Order-nr. 0128000M)

4: Escutcheon (Order-nr. 48005000)

5: Shank mounting kit (Order-nr. 46249000)

6: Connection hose (Order-nr. 46255000)

7: Screw for Costa/Avina products (Order-nr. 48013000)\*

8: Mounting wrench (Order-nr. 19017000)\*

\* Optional accessories