

## 31 221 000 GROHE BAUCURVE SINK TAP 1/2"

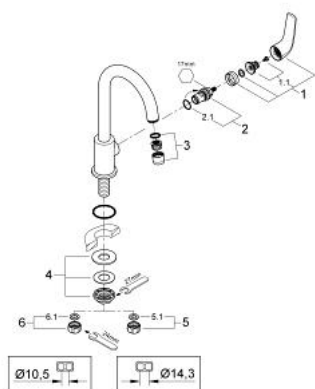

**SELECT SPARE PART:** , June 2010 – spareParts.validDate.now

1: Handle (Order-nr. 48120000)

1.1: Replacement handle connection kit (Order-nr. 45186000)

1.1.1: O-ring  $\varnothing 18.2 \times \varnothing 1.7$  (Order-nr. 0392400M)

2: Ceramic headpart, 1/2" (Order-nr. 45882000)

2.1: O-ring  $\varnothing 18.2 \times \varnothing 1.7$  (Order-nr. 0392400M)

3: Mousseur (Order-nr. 13928000)

4: Shank mounting kit (Order-nr. 45004000)

5: Coupling nut 1/2" x 14.5 mm (Order-nr. 1290200M)

5.1: Fibre seal dia. 12x2 mm (Order-nr. 0138900M)

6: Coupling nut 1/2" x 10.5 mm (Order-nr. 1290100M)

6.1: Fibre seal dia. 12x2 mm (Order-nr. 0138900M)