

31 187 001 **COSTA L WALL SINK MIXER 1/2"**

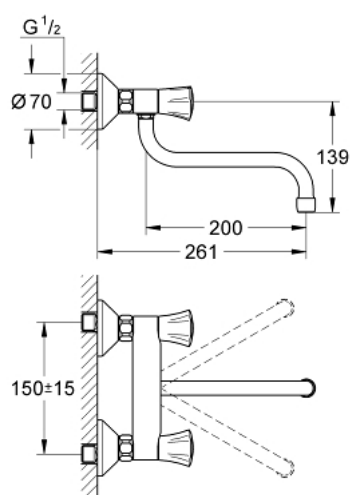

PRODUCT DESCRIPTION

- Colour: chrome
- metal handles
- heat-insulated
- GROHE Long-Life finish
- GROHE Long-Life headparts
- mousseur
- swivel tubular spout
- swivel area 360°
- projection 200 mm
- S-unions
- maximum flow rate (at 3 bar): 13 l/min



31 187 001 **COSTA L WALL SINK MIXER 1/2"**



SELECT SPARE PART: , June 2007 – spareParts.validDate.now

1: Handle (Order-nr. 45994000)

1.1: Repl. kit f.handle fastening (Order-nr. 0538600M)

2: Headpart 1/2" (Order-nr. 07146000)

2.1: O-ring $\varnothing 6 \times \varnothing 2$ (Order-nr. 0128300M)

2.2: O-ring $\varnothing 18.2 \times \varnothing 1.7$ (Order-nr. 0392400M)

2.3: Ball seal dia. 9x6.8 mm (Order-nr. 0529100M)

3: Screw joint (Order-nr. 45044000)

4: S-union (Order-nr. 12075000)

4.1: Ball seal dia. 9x6.8 mm (Order-nr. 0138600M)

4.2: Escutcheon (Order-nr. 0221000M)

5: Swivel tube spout (Order-nr. 13051000)

5.1: O-ring dia. 12x2 mm (Order-nr. 0128000M)

5.2: Mousseur (Order-nr. 13928000)

6: Extension 3/4", 20 mm (Order-nr. 0713000M)*

7: Screw for Costa/Avina products (Order-nr. 48013000)*

* Optional accessories