

23 334 000 BAUEDGE SINGLE-LEVER BATH/SHOWER MIXER

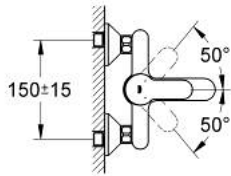

PRODUCT DESCRIPTION

- Colour: chrome
- wall mounted
- metal lever
- GROHE SmoothControl 46 mm ceramic cartridge
- GROHE LongLife finish
- adjustable flow rate limiter
- automatic diverter: bath/shower
- spout with mousseur
- shower bottom outlet 1/2" with integrated non return-valve
- S-unions
- metal wall escutcheon
- protected against backflow
- optional temperature limiter ref. no. 46 375 000

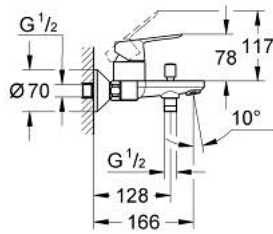

23 334 000 BAUEDGE SINGLE-LEVER BATH/SHOWER MIXER

SELECT SPARE PART: , September 2012 – now

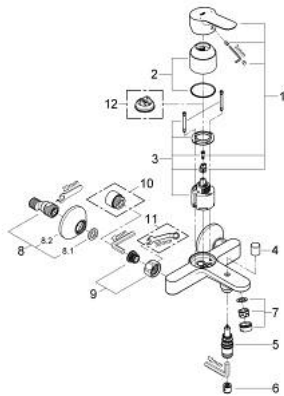

- 1: Lever (Spare part-nr. 46698000)
 - 2: Shield (Spare part-nr. 46584000)
 - 3: Cartridge (Spare part-nr. 46048000)
 - 4: Diverter knob (Spare part-nr. 64309000)
 - 5: Diverter (Spare part-nr. 65655000)
 - 6: Non-return valve (Spare part-nr. 08565000)
 - 7: Mousseur (Spare part-nr. 13952000)
 - 8: S-union (Spare part-nr. 12075000)
 - 8.1: Ball seal dia. 9x6.8 mm (Spare part-nr. 0138600M)
 - 8.2: Escutcheon (Spare part-nr. 0221000M)
 - 9: Screw joint (Spare part-nr. 45044000)
 - 10: Extension 3/4", 20 mm (Spare part-nr. 0713000M)*
 - 11: Special spanner (Spare part-nr. 19377000)*
 - 12: Temperature limiter (Spare part-nr. 46375000)*
- * Optional accessories