

## 21 375 001 **COSTA L SINGLE-HOLE BASIN MIXER**

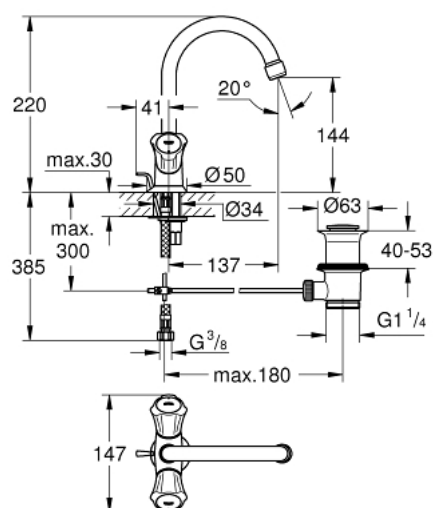

### PRODUCT DESCRIPTION

- Colour: chrome
- metal handles
- heat-insulated
- screwable
- GROHE Long-Life headpart
- swivel tubular spout with mousseur
- pop-up waste set 1 1/4"
- flexible connection hoses
- GROHE Long-Life finish



## 21 375 001 **COSTA L SINGLE-HOLE BASIN MIXER**

**SELECT SPARE PART:** , July 2018 – spareParts.validDate.now

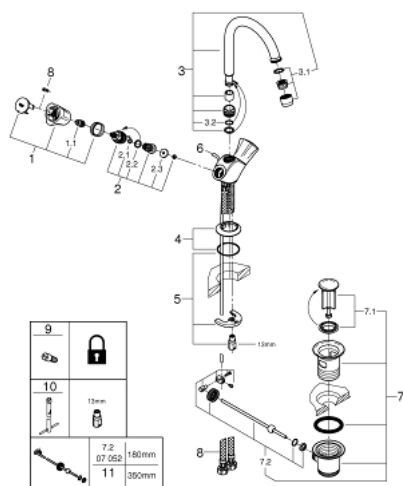

1: Handle (Order-nr. 45994000)

1.1: Repl. kit f.handle fastening (Order-nr. 0538600M)

2: Headpart 1/2" (Order-nr. 07146000)

2.1: O-ring  $\varnothing 6 \times \varnothing 2$  (Order-nr. 0128300M)

2.2: O-ring  $\varnothing 18.2 \times \varnothing 1.7$  (Order-nr. 0392400M)

2.3: Ball seal dia. 9x6.8 mm (Order-nr. 0529100M)

3: Spout (Order-nr. 13219000)

3.1: Mousseur (Order-nr. 13928000)

3.2: O-ring dia. 12x2 mm (Order-nr. 0128000M)

4: Escutcheon (Order-nr. 48004000)

5: Shank mounting kit (Order-nr. 46249000)

6: Lift rod (Order-nr. 65936PD0)

7: Pop-up waste set 1 1/4" (Order-nr. 28910000)

7.1: Plug (Order-nr. 07182000)

7.2: Eccentric rod (Order-nr. 07052000)

8: Connection hose (Order-nr. 46255000)

9: Screw for Costa/Avina products (Order-nr. 48013000)\*

10: Mounting wrench (Order-nr. 19017000)\*

11: Eccentric rod (Order-nr. 07341000)\*

\* Optional accessories