

20 191 00A **ALLURE 3-HOLE BASIN MIXER**  
**M-SIZE**

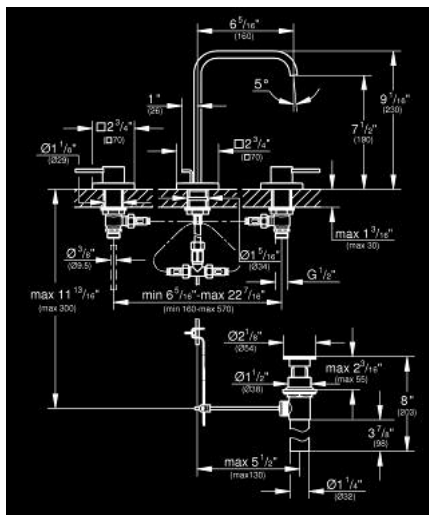

**PRODUCT DESCRIPTION**

- Colour: chrome
- with lever handles
- metal escutcheons
- ceramic headparts 1/2", 90°
- GROHE LongLife finish
- spout with mousseur
- pressure-proof, flexible connection hoses between spout and side valves
- pop-up waste set 1 1/4"
- max. flow rate 4.5 l/min (1.2 gpm)



20 191 00A **ALLURE 3-HOLE BASIN MIXER**  
**M-SIZE**

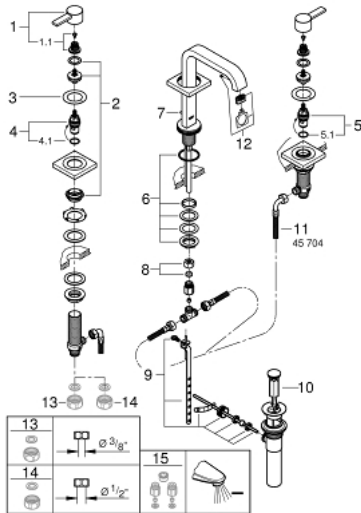

**SELECT SPARE PART:** , March 2020 – now

- 1: Handle (Spare part-nr. 48043000)
  - 1.1: Replacement handle connection kit (Spare part-nr. 45186000)
  - 1.1.1: O-ring  $\varnothing 18.2 \times \varnothing 1.7$  (Spare part-nr. 0392400M)
  - 2: Extension (Spare part-nr. 48045000)
  - 3: Sealing washer (Spare part-nr. 48047000)
  - 4: Ceramic headpart, 1/2" (Spare part-nr. 45882000)
  - 4.1: O-ring  $\varnothing 18.2 \times \varnothing 1.7$  (Spare part-nr. 0392400M)
  - 5: Ceramic headpart, 1/2" (Spare part-nr. 45883000)
  - 5.1: O-ring  $\varnothing 18.2 \times \varnothing 1.7$  (Spare part-nr. 0392400M)
  - 6: Shank fastening assembly (Spare part-nr. 45025000)
  - 7: Pop-up rod (Spare part-nr. 65196000)
  - 8: Compression union 3/8" (Spare part-nr. 12914000)
  - 8.1: Ball seal dia. 9x6.8 mm (Spare part-nr. 45279000)
  - 9: Ball rod (Spare part-nr. 48332000)
  - 10: Plug (Spare part-nr. 48331000)
  - 11: Flexible connection hose (Spare part-nr. 45704000)
  - 12: Mousseur (Spare part-nr. 13220000)
  - 13: Coupling nut 1/2" x 10.5 mm (Spare part-nr. 1290100M)\*
  - 14: Coupling nut 1/2" x 14.5 mm (Spare part-nr. 1290200M)\*
  - 15: Water saving set (Spare part-nr. 48189000)\*
- \* Optional accessories