

20 187 ALC EUROSART COSMOPOLITAN 3-HOLE BASIN MIXER S-SIZE

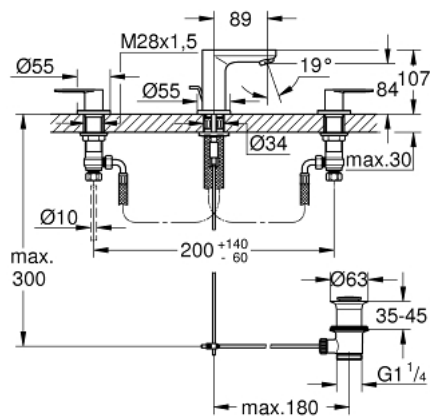

PRODUCT DESCRIPTION

- Colour: brushed hard graphite
- metal lever
- ceramic headparts $1/2''$, 90°
- GROHE LongLife finish
- GROHE FastFixation installation system with centering support
- spout with mousseur
- pop-up waste set $1 \frac{1}{4}''$
- pressure-proof, flexible connection hoses between spout and side valves
- union nut with 10.5 mm drilling

20 187 ALC EUROSART COSMOPOLITAN 3-HOLE BASIN MIXER S-SIZE

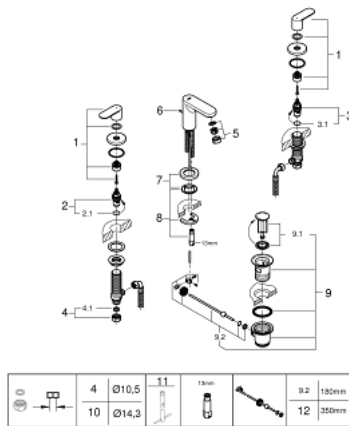

SELECT SPARE PART: , September 2021 – now

- 1: Eurosmart Cosmopolitan pair of handles (Spare part-nr. 48306AL0)
 - 2: Ceramic headpart, 1/2" (Spare part-nr. 45882000)
 - 2.1: O-ring $\varnothing 18.2 \times \varnothing 1.7$ (Spare part-nr. 0392400M)
 - 3: Ceramic headpart, 1/2" (Spare part-nr. 45883000)
 - 3.1: O-ring $\varnothing 18.2 \times \varnothing 1.7$ (Spare part-nr. 0392400M)
 - 4: Coupling nut 1/2" x 10.5 mm (Spare part-nr. 1290100M)
 - 4.1: Fibre seal dia. 12x2 mm (Spare part-nr. 0138900M)
 - 5: Mousseur (Spare part-nr. 48159AL0)
 - 6: Pop-up rod (Spare part-nr. 46739AL0)
 - 7: Shank mounting kit (Spare part-nr. 46671000)
 - 8: Pop-up waste set 1 1/4" (Spare part-nr. 28910AL0)
 - 8.1: Plug (Spare part-nr. 07182AL0)
 - 8.2: Eccentric rod (Spare part-nr. 07052000)
 - 9: Coupling nut 1/2" x 14.5 mm (Spare part-nr. 1290200M)*
 - 10: Mounting wrench (Spare part-nr. 19017000)*
 - 11: Eccentric rod (Spare part-nr. 07341000)*
- * Optional accessories