

19 919 00A GRANDERA 5-HOLE BATH/SHOWER COMBINATION

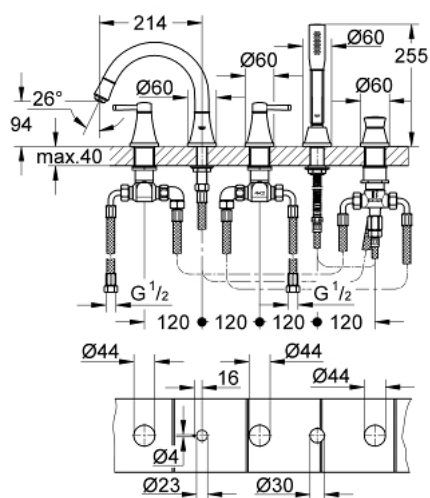

PRODUCT DESCRIPTION

- Colour: chrome
- ceramic headparts 1/2", 90°
- GROHE Long-Life finish
- consisting of:
 - pre-assembled spout fixing
 - single lever mixer operating element
 - bath spout with mousseur and diverter bath/shower
 - Grandera hand shower 6.6 l/min
 - metal shower hose 1500 mm
 - flexible connection hoses
 - connection for shower hose
 - protected against backflow
 - can be used with 29 037 000
 - min. recommended pressure 1.0 bar

19 919 00A GRANDERA 5-HOLE BATH/SHOWER COMBINATION

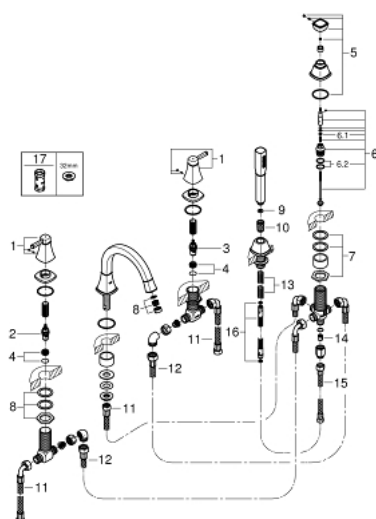

SELECT SPARE PART: , October 2018 – spareParts.validDate.now

- 1: Handle pair (Order-nr. 48325000)
- 2: Ceramic headpart 3/4", 180° (Order-nr. 45888000)
- 3: Ceramic headpart 3/4", 180° (Order-nr. 45887000)
- 4: Seat 3/4" (Order-nr. 45345000)
- 5: diverter knob (Order-nr. 48216EN0)
- 6: Diverter (Order-nr. 45443000)
- 6.1: O-ring $\varnothing 6 \times \varnothing 2$ (Order-nr. 0128300M)
- 6.2: Seat washer (Order-nr. 0120500M)
- 7: Repl.kit f.shank fastening 3/4" (Order-nr. 45444000)
- 8: Mousseur (Order-nr. 13952EN0)
- 9: Dirt strainer (Order-nr. 0700200M)
- 10: Cone nut (Order-nr. 08864EN0)
- 11: Tube (Order-nr. 48018000)
- 12: Tube (Order-nr. 48019000)
- 13: Compression spring (Order-nr. 00869000)
- 14: Non-return valve (Order-nr. 08565000)
- 15: Tube (Order-nr. 07300000)
- 16: Metal hose (Order-nr. 28146000)
- 17: Socket spanner (Order-nr. 19332000)*

* Optional accessories