

19 809 001 COSTA L CONCEALED VALVE EXPOSED PART

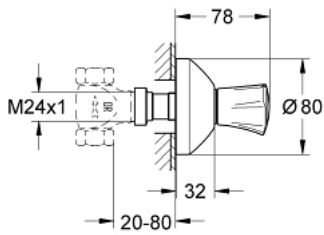

PRODUCT DESCRIPTION

- Colour: chrome
- trim set for 35 028 000
- for GROHE concealed valves, 1/2", 3/4", 1"
- installation depth infinitely adjustable 20-80 mm
- escutcheon with wall sealing
- screwable
- metal handle
- heat-insulated
- marking: red
- GROHE LongLife finish



19 809 001 COSTA L CONCEALED VALVE EXPOSED PART

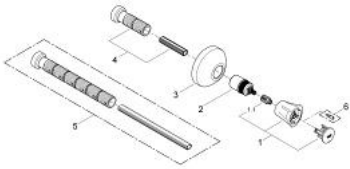

SELECT SPARE PART: , February 2008 – now

1: Handle (Spare part-nr. 45994000)

1.1: Repl. kit f.handle fastening (Spare part-nr. 0538600M)

2: Extension (Spare part-nr. 45204000)

3: Escutcheon (Spare part-nr. 45219000)

4: Extension 20-80 (Spare part-nr. 45202000)

5: Extension 20-200 (Spare part-nr. 45203000)*

6: Screw for Costa/Avina products (Spare part-nr. 48013000)*

* Optional accessories